

COMM-SITA 6000 HORIZONTAL DISCHARGE REFUSE COLLECTION VEHICLES

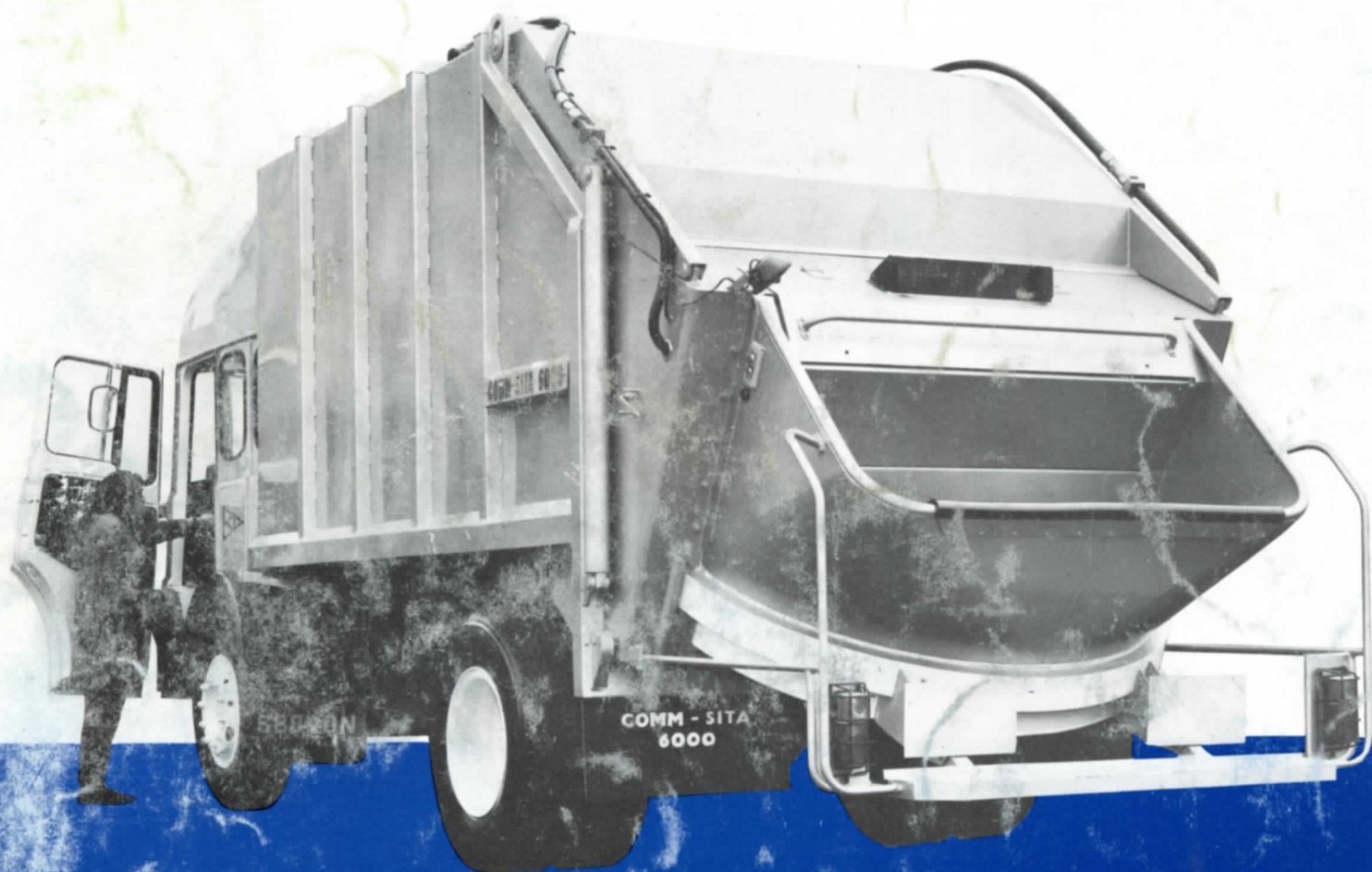

**R Bradley
Municipal
Vehicles Limited**

COMM-SITA 6000 FOR

The Comm-Sita 6000 is becoming the favourite choice for Britain's more progressive local authorities.

Completely British-built, the Comm-Sita, is quiet quality at a realistic price and with a reasonable delivery.

The operation of the Comm-Sita is unique, simple and effective. The body is charged with refuse by the continuous 180° sweep action of the rammer in the hopper. Within the body is a scientifically shaped ejector plate which is moved back as the refuse is compressed against it by the continuous ramming. Compaction of average household refuse into the 16 cu. m. (21 cu. yds.) body is about 4 to 1 giving a compacted volume of up to 65 cu. m. (85 cu. yds.).

Discharge is fast and easy with an average discharge time of about 20 seconds. Only two levers are operated, — one lever controls the raising and lowering of the rear door and hopper with automatic locking and unlocking. The other lever operates the ejector plate. Although no seals are used, spillage between the rear door structure and the body is not possible.

The Comm-Sita is ideally matched to its chassis — a Seddon Municipal 'Lowline' with a short 3.5 m. (11'3") wheelbase and 16.25 tonnes (16 ton) GVW. Or chassis can be provided to your specification.

It has a seven man crew cab with two large, low entry doors to provide easy access. It is fully equipped to a very high standard for both comfort and safety.

The horizontal discharge Comm-Sita is highly flexible in operation. The vehicle's quietness is an important feature. 62½ decibels in independent tests.

One of the greatest advantages of this vehicle is economy. There are very few moving parts and this not only ensures simplicity in operation, it also means that maintenance costs are very low. Low energy absorption also means low running costs.

More and more local authorities are changing to Comm-Sita. Ask a user what he thinks about Comm-Sita and then ring us for a demonstration.

STANDARD FEATURES

- 1 Seven man crew cab with many features for comfort, safety and efficiency.
- 2 Low step height and large door for easy access.
- 3 Short wheelbase — only 3.5 m (11'3") 16.25 tonnes (16 tons) GVW.
- 4 16 cu. m. (21 cu. yds.) capacity with high flexibility — continuous loading.
- 5 Perkins 6.354.2, 120 BHP diesel engine. 355 mm. (14") clutch EATON 5 speed constant mesh gearbox. Or chassis to your specification.
- 6 Efficient ejector mechanism — 20 second horizontal ejection.
- 7 Very few moving parts — simplicity in operation, low maintenance, minimum running costs.
- 8 Automatic paper and polythene bag ripper — no air cushioning.
- 9 Protection. All systems automatically protected from abuse.
- 10 Rammer post formed from 230 mm. (9") O/D manganese steel alloy hollow bar with two double taper roller bearings.
- 11 Rear door structure lifts clear of body for refuse ejection — but allows operation in low headroom incinerating stations.
- 12 High speed loading — 3.44 cu. m. (4½ cu. yds.) per minute.
- 13 Simple low pressure hydraulic system operates loading, raising and rear door opening.
- 14 Magnetic clutch prevents over revving of the hydraulic systems i.e. Drive is disconnected at 1400 RPM, also protects gear change.

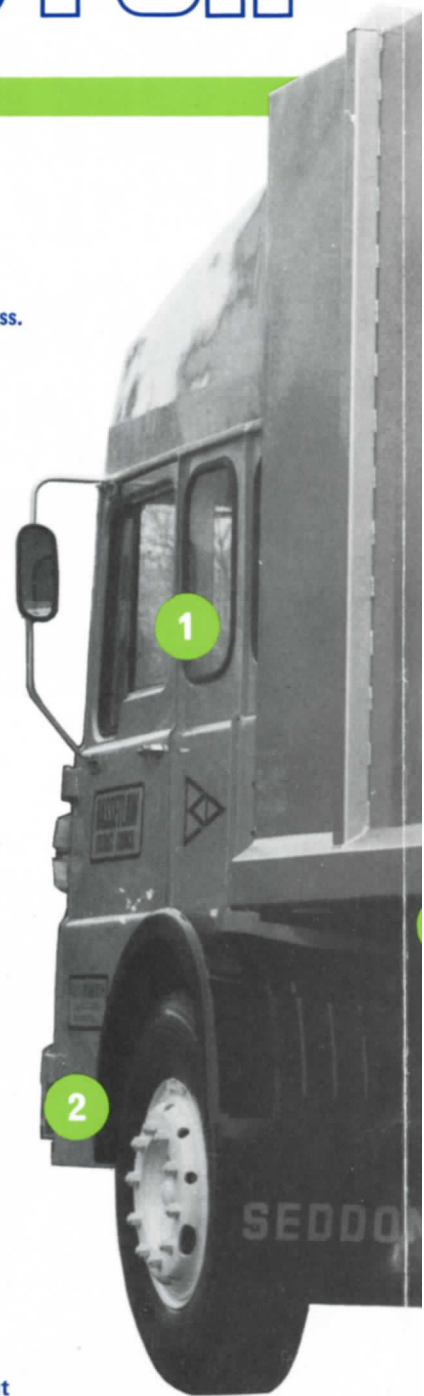

LOADING & DISCHARGE CYCLE

The Comm-Sita is a continuous loading machine.



At the start of the loading cycle the ejector plate is positioned at the rear of the body.



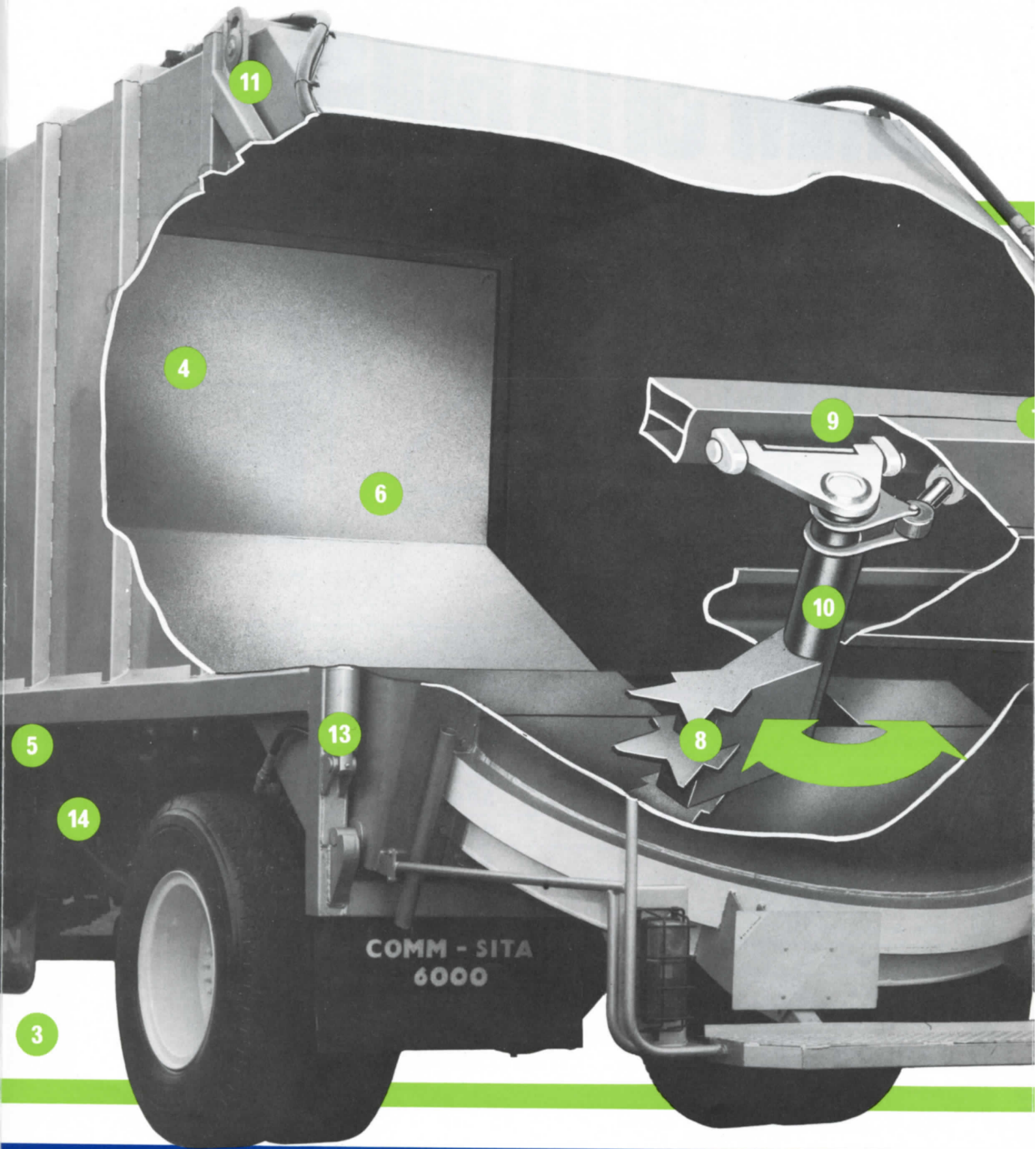

As refuse is emptied into the hopper the rammer packs it against the ejector plate.



The steady 180° sweep action of the rammer ensures efficient compaction.



There is no air cushioning in the body during loading. Paper and polythene bags are automatically ripped.



EFFICIENT RELIABILITY

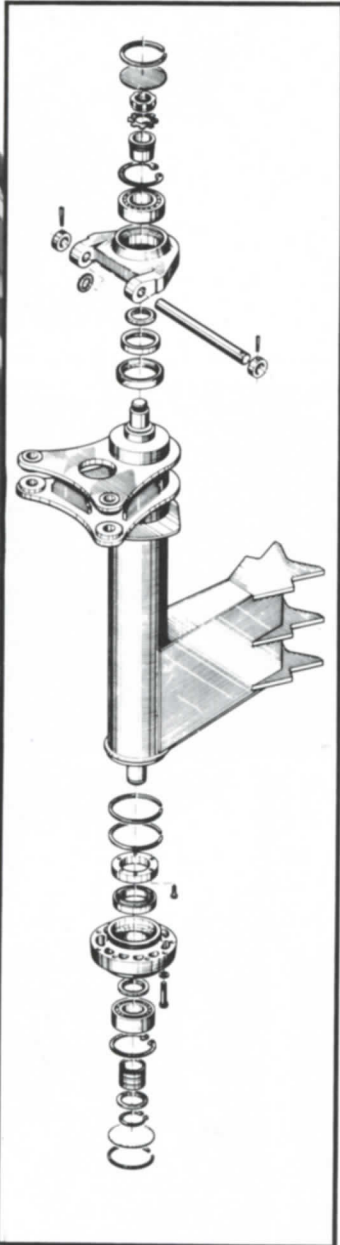

STANDARD VARIATIONS



6000L

For those authorities requiring increased payloads a 3.7 m. (12') wheelbase version of the Comm-Sita 6000 is available. Designated the 6000L it incorporates all the design features of the standard machine.



6000R

This machine is fitted with a round bin lift to handle bar and non-bar 1 cu. m. (1¼ cu. yds.) palladin type bins of up to one ton capacity. Domestic bins can be loaded on either side of the bin lift equipment.

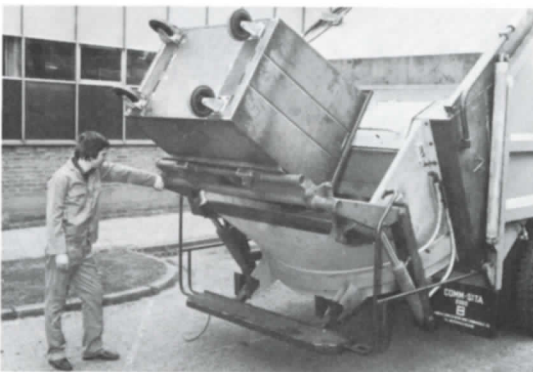

6000S

Fully dual purpose vehicle

The 6000 S is designed to lift rectangular bins. It will handle three sizes of bins up to 1.3 cu. m. (1¼ cu. yds.). The lift equipment fits vertically under the lip of the hopper and does not obstruct domestic loading in any way.

When loading is complete the refuse is uniformly compacted up to 65 cu. m. (85 cu. yds.) in a 16 cu. m. (21 cu. yds.) body.



The rear door structure is lifted and the ejector plate is actuated to empty the body in 20 seconds.

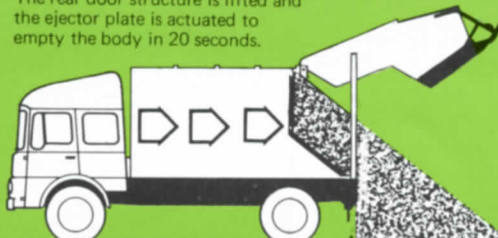

The Comm-Sita has completed its loading and discharge cycles quickly, quietly and economically. Many local authorities throughout the U.K. have welcomed the high performance manoeuvrability and reliability of the Comm-Sita 6000.

HIGH PERFORMANCE

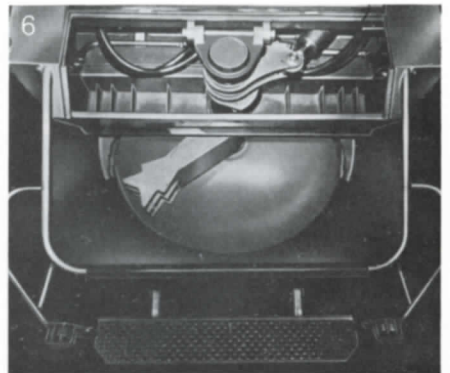

1. The Comm-Sita 6000 has a cab which creates no difficulties for its crew. It is ergonomically efficient with low step height, wide door and a high roof to allow easy changing. The wheelbase of the standard machine is only 3.5 m. (11'3").

2. The Comm-Sita 6000 is British-built. It has been in production since 1974 and many units have now seen long service with local authorities. The bodies are built at BMV manufacturing unit at Clay Cross, Chesterfield.

3. Crews are happy with the Comm-Sita 6000. So much careful design and decades of practical experience have contributed to its features.

4. The body will carry a compacted volume of up to 65 cu. m. (85 cu. yds.) of household refuse. Compaction is thorough and even. Discharge takes about 20 seconds.

5. with the hopper raised the vehicle is still only 4.2 m. (13'9") high. It is raised by single lever operation and is automatically locked and unlocked.

6. The body is charged with refuse by the 180° sweep action of this rammer in the large capacity hopper. Compaction is dense and a polythene bag ripper is fitted.

7. The door opens 90°. The cab is well fitted with handrails and padding for extra safety. The seats are easily cleaned.

COMM-SITA 6000

The company's policy is one of continuous product improvement, specifications therefore are liable to alteration at any time.

Manufactured under licence from Société Industrielle de Transports Automobiles (S.I.T.A.)

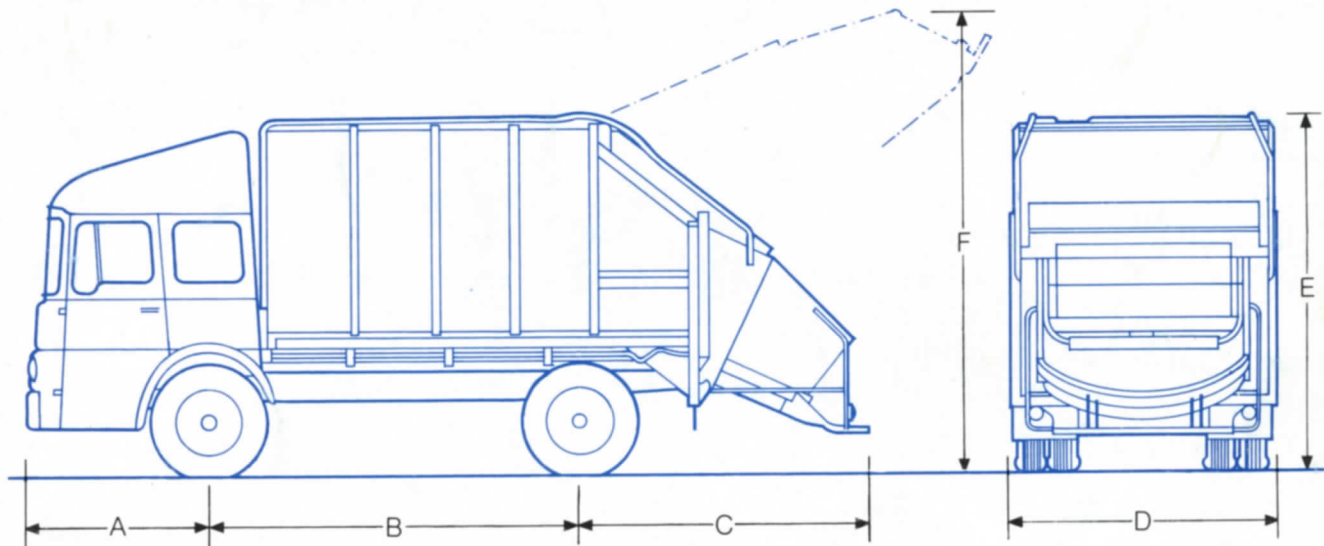

Front Overhang	A	1.6 m.	5' 2"
Wheelbase	B	3.5 m.	11' 3"
Rear Overhang	C	2.6 m.	8' 8"
Overall Length	A + B + C	7.7 m.	25' 1"
Overall Width	D	2.5 m.	8' 0"
Overall Height	E	3.3 m.	10' 9"
Overall Height – Hopper Raised	F	4.2 m.	13' 9"
Tare Weight		8.6 tonnes	8 tons 9 cwt. 1 qr.
Front Axle Laden		5.08 tonnes	5 tons
Rear Axle Laden		10.16 tonnes	10 tons
Body Capacity		61/65 cu. m.	80/85 cu. yds.
Charge Rate		3.5 cu. m./minute	4½ cu. yds./minute
Rammer Force		7.62 tonnes	7.5 tons
Ejection Time		20 seconds	20 seconds

British Patent Number 1032920



**R Bradley
Municipal
Vehicles Limited**

R. Bradley Municipal Vehicles Ltd.

Derby Road, Clay Cross,
Chesterfield, Derbyshire
Telephone: 0246-863456
Telex: 547021

A member of R. Bradley Motor Holdings Limited