

DELTA[®]-III

REAR LOADER

Featuring the Series III Rounded Body
and the Delta Tailgate

New!
The Industry's Choice
Rounded Body



The Mid-Compaction, Full-eject, Versatile Rear Loader

The Residential Workhorse

The new Delta-III rear loader with the “industry’s choice” rounded body is the all-round perfect candidate for residential collection. Choose from 14 to 20-yard body sizes along with a wide range of accessories, including cart tippers and commercial handling options. With a roomy 3-cubic yard hopper and compaction ratings of 800 lbs., the Delta-III can be your residential workhorse dawn to dusk.

Designed for Strength and Performance

- Mid-compaction ratings – 800 lbs./cu. yd.
- Floor-Trough™ design strengthens entire body while providing a natural sump for liquid containment
- Efficient single-stage full-eject cylinder positioned off the floor to protect shaft and seals from damage
- Heavy-duty abrasion-resistant steel hopper bottom for maximum durability

Built for Maintenance and Operating Efficiency

- Curbside dual-lever packing controls
- All lights sealed and grommet mounted; rear lights on upper panel and hopper utility lights standard; heat-shrink wire connections throughout
- Low loading height for operator convenience
- Full range of optional container handling systems
- Easily removable ejection panel shoes located front and rear of panel
- Meets ANSI Z-245.1 safety standards

LEACH[®]
Subsidiary of Federal Signal Corporation

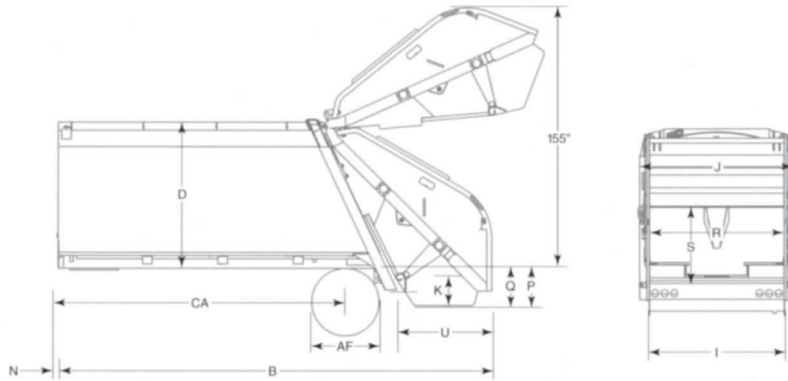

DELTA-III

	SINGLE AXLE			
BODY DIMENSIONS	14 CU. YD. (11 CU. M)	16 CU. YD. (12 CU. M)	18 CU. YD. (14 CU. M)	20 CU. YD. (15 CU. M)
B Overall Length	192" (4,877 mm)	204" (5,182 mm)	217" (5,512 mm)	230" (5,842 mm)
CA (Note 2)	93" (2,362 mm)	106" (2,692 mm)	118" (2,997 mm)	131" (3,327 mm)
• Min. Truck GVWR Requirement (Note 1)	28,000 lbs. (12,701 kg.)	30,000 lbs. (13,608 kg.)	31,500 lbs. (14,288 kg.)	33,000 lbs. (14,969 kg.)

BODY DIMENSIONS	SINGLE AXLE - ALL SIZES
AF After Frame	38" (965 mm)
D Height Above Chassis Frame	93" (2,362 mm)
I Body - Outside Width	96" (2,438 mm)
J Body - Inside Width (Max)	90" (2,286 mm)
K Hopper Depth	16" (406 mm)
N Start of Clear CA to Body Front	2" (51 mm)
P Top of Step Below Chassis Frame	23" (584 mm)
Q Hopper Bottom Below Chassis Frame	25" (635 mm)
R Hopper Opening Width	84" (2,134 mm)
S Hopper Opening Height	59" (1,499 mm)
U Rear of Body to Rear of Tailgate, Closed	57" (1,448 mm)
• Height Above Chassis Frame (Tailgate Raised)	155" (3,937 mm)
• Load Sill Below Chassis Frame	5" (127 mm)
• Hopper Capacity	3.0 cu. yd. (2.3 m ³)

Features

- Sides, front and rear reinforced with electrically welded box sections.
- Contents of body sealed off from outside during compaction cycle.
- Steps and grab handles both sides of tailgate.
- Buzzer system provided both sides at rear to enable loaders to signal driver.
- Load is ejected by simple, easily maintained, double-acting cylinder.
- Dual-lever packing controls at rear of hopper ... curbside.
- Single-lever ejection control at front of body ... street side.
- Single-lever tailgate lift control at front of body ... street side.
- Leach exclusive polyurethane paint process. White standard. Other colors optional.
- Meets all ANSI Z-245.1 Safety Standards.

Notes: 1. Truck selected must be capable of carrying net weight of body plus weight of refuse to be collected.
2. CA must be usable with no obstructions protruding above frame.

Hydraulic System

- Cylinders
 - (2) 4" double-acting packer plate cylinders
 - (2) 4.5" double-acting carrier plate cylinders
 - (2) 4" single-acting tailgate lift cylinders

Ejection Cylinder

Body Size	Stages	Sizes
14	1	4
16	2	5x4
18	2	5x4
20	2	5x4

- Pump
 - Leach - gear type pressure compensating
 - Capacity - 38 GPM @ 1,200 RPM

- Maximum Operating Pressure - 2,300 PSI
- Hydraulic Tank
 - Capacity - 50 gallons
 - Location - Right-hand front on floor inside body
 - Filters - 141 micron in-line suction strainer with by-pass valve
 - 10 micron return line filter with by-pass valve

- Sight gauge - located on tank at eye level

Body Construction

- Sides - 11 gauge Hi-Tensile, 80,000 PSI
- Top - 11 gauge Hi-Tensile, 80,000 PSI
- Floor - 50,000 PSI steel
- Floor-Trough - one-piece steel construction

Tailgate Construction

- Hopper sides - 3/16" 80,000 PSI
- Hopper bottom - 3/16" 100,000 PSI
- Packer and carrier plates - 3/16" 50,000 PSI
- Top Sheet - Secured with fasteners ... easily removed for maintenance

Optional Equipment

- Container handling
- Cart tipper (S)
- Lighting packages
- Many others available upon request

C. N. WOOD CO., INC.
200 MERRIMAC STREET
WOBURN, MA 01801

LEACH[®]
Subsidiary of Federal Signal Corporation

920-231-2770 Phone
920-231-2712 Fax
Leach Company
2737 Harrison Street
P.O. Box 2608
Oshkosh, WI, U.S.A. 54903
www.LeachUSA.com

