

***PROUD, &
PROFITABLE!***



R  YAL GT





High
Ample
All we
Polye

Phos
fini
out
14 T
Hea
for
Ten m
All pis
Hoses
ope

The
du

What do you want in a packer? Large hopper — easy packing — good payload — standard parts — maintenance accessibility — dependability — low height — easy turning to get in and out of tight places — excellent industrial design. You get them all in the Royal GT series. There's one to fit your requirements.

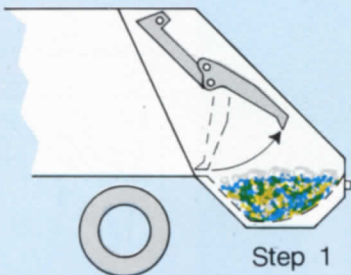

Step 1

Start: Sweep blade raises.

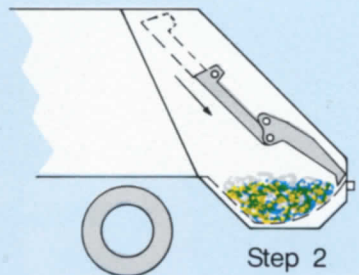

Step 2

Sweep and carriage blades slide down over the loaded hopper.

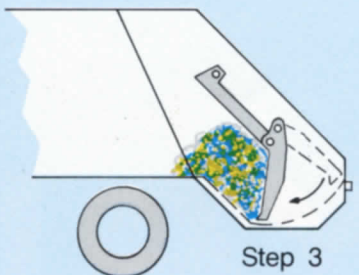

Step 3

Sweep blade pivots down to sweep the hopper clean.

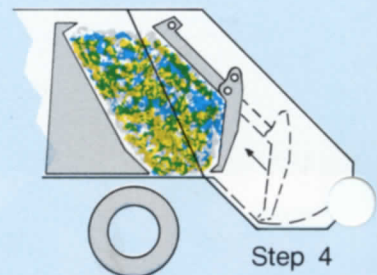

Step 4

Sweep and carriage blades slide up to pack the refuse tightly into the body.

CONSIDER THESE FEATURES

High strength steel used throughout.
Double reinforcement at stress points.
Welds are made with a submerged arc.
Neurathane Tailgate Seal for long life.
Phosphate pre-coat etched/zinc chromate primer/two
finish coats of high quality automotive enamel — an
outstanding paint job.
Ejector blade force for quick discharge of load.
Heavy duty P.T.O. and direct coupled pump to eliminate need
for U joint.
1 micron replaceable (spin-on) filter for easy replacement.
Ejector rods heavy chrome-plated alloy steel.
Blades and Tubes have burst safety factor of five times normal
operating pressure.

All combine to reduce maintenance and increase pro-
ductive life.



Container Dumper —

Using the optional hydraulically powered container dumper unit allows easy dumping of up to 3 cubic yard containers. The packing blades can be cycled while the container is being lifted to help empty the container and speed the operation. It's easy — it's fast.

ROYAL GT



Hopper

The 1 $\frac{1}{2}$ yard hopper is the largest of any of the smaller packers. Hopper loading height makes work easier, faster and safer. Packing cycle allows rapid hopper reloading.



Controls —

Only the Royal GT offers semi automatic hydraulic blade controls as standard with straight manual or completely automatic controls optionally available. Choose the control system that best fits your particular needs.



Be Proud

The clean, uncluttered appearance of the Royal GT reflects the attention given to styling in its design. The lines of the body, uncluttered and pleasing to the eye, demonstrate the user's pride in the equipment he operates. The Royal GT is robust and — yet — beautiful.



Tailgate —

The fully elevating tailgate, combined with a smooth, self-cleaning ejector blade and robust ejector cylinder provide rapid and complete load removal at the landfill.

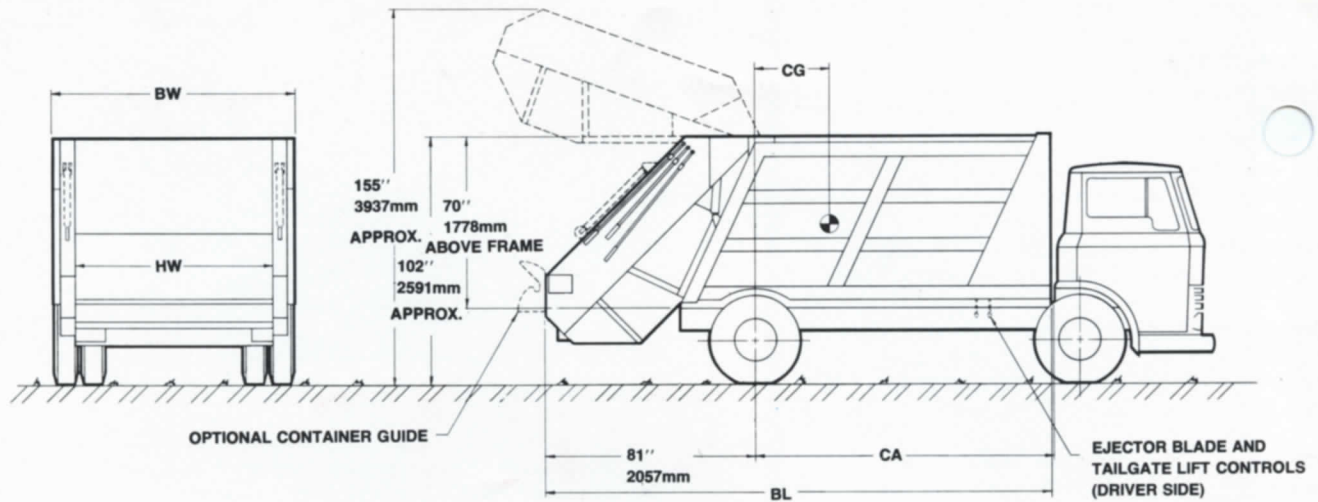

MODEL	ROYAL GT-9		ROYAL GT-10		ROYAL GT-14	
	English	Metric	English	Metric	English	Metric
Capacity	9 cu. yd.	7 cu. M	10 cu. yd.	7.7 cu. M.	14 cu. yd.	10.7 cu. M.
Body weight	6100 lb.	2773 kg.	6250 lb.	2840 kg.	6700 lb.	3045 kg.
Recommended Chassis CA	84 in.	2134 mm	84 in.	2134 mm	120 in.	3048 mm
Recommended Chassis G.V.W.	18,000 lb.	8180 kg.	20,000 lb	9090 kg.	26,000 lb.	11,818 kg.
Rear axle to CG (Full)	11 in.	280 mm	11 in.	280 mm	23 in.	585 mm
B.L.	168 in.	4267 mm	168 in.	4267 mm	204 in.	5182 mm
B.W.	80 in.	2032 mm	92 in.	2337 mm	92 in.	2337 mm
H.W.	62 in.	1575 mm	74 in.	1880 mm	74 in.	1880 mm

**Facts for all RGT Models:
Body Construction**

Material: All hi-strength steel sheet, structural members and formed sections

Hydraulics:

Pump — Gear type — 19 gpm @ 1200 rpm

Working Pressure — 1800 psi

Hoses and Tubes — 9000 psi burst pressure

Cylinder: Honed tube bores, chrome plated rods, polyurethane seals

Packing Cycle: From 15 to 20 seconds — depending on PTO ratio and engine speed.

"The company reserves the right under its product improvement policy to change construction or design details and furnish this latest equipment without reference to illustrations or specifications used herein".

PRINTED IN U.S.A.

DISTRIBUTOR:

WAYNE ENGINEERING CORPORATION

2412 W 27 St., Box 648,
Cedar Falls, Iowa 50613
Phone (319) 266-1721